

WELCOME

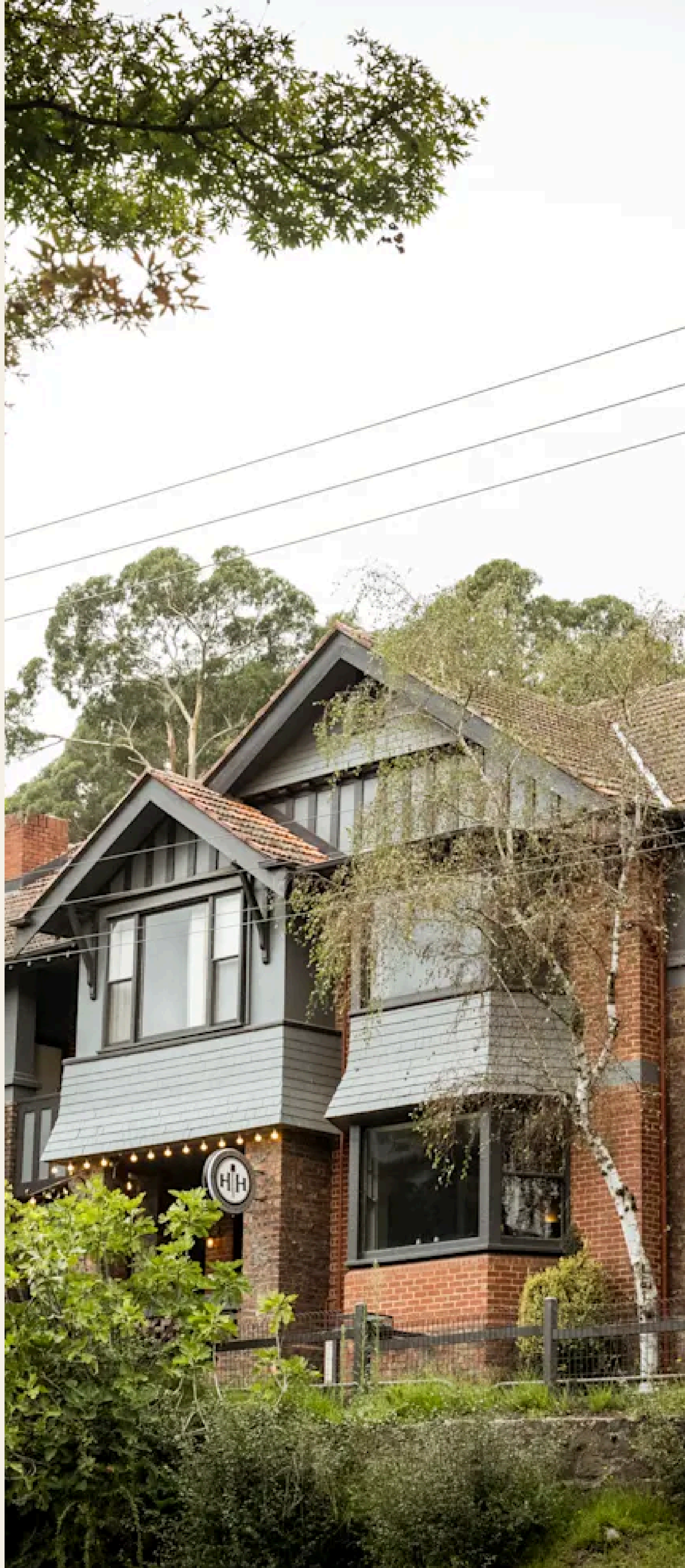

The Alpine Hotel

EAT DRINK STAY



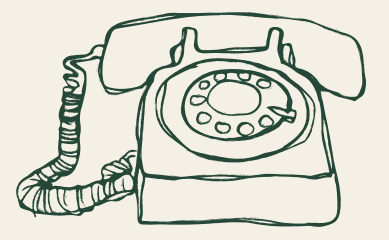

YOUR GUIDE

TAP THE ICONS



WELCOME



**CHECK
IN / OUT**



**HOTEL
MAP**



AMENITIES



BIKES



**HOUSE
RULES**



EXPLORE



FAQ



**EMERGENCY
PROCEDURES**



DRINKS & DINING

REVIEW



WELCOME



Welcome to our hotel!
Thank you for choosing to stay with us.

We hope you settle in, unwind, and feel right at home while enjoying everything our hotel and the Yarra Valley have to offer.

Take your time to relax, explore, and enjoy the surrounds.

Reception Hours

We're a heritage hotel in a small country town, so reception is open when we are!

11:00am - 9:00pm

A night manager is available outside these hours for urgent matters or emergencies only.

0437 990 297

TAP ICONS TO NAVIGATE

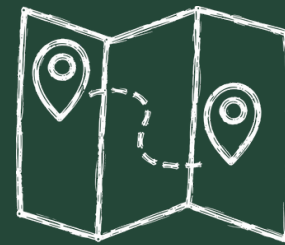

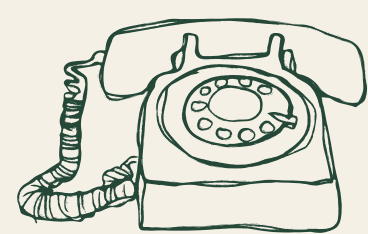

CHECK IN

3:00pm

On arrival, please head to reception in the centre of the building where our team will assist you with check-in and provide your room details.

If you are arriving outside reception hours, please contact us prior to your stay so we can arrange after-hours access instructions.

CHECK OUT

10:00am

Monday - Friday

Please leave your key in your room door and exit via the hotel back door on your floor. The downstairs entrance remains locked until 11am

Weekends

Please head down the main stairs and return your keys to reception on departure.

TAP ICONS TO NAVIGATE

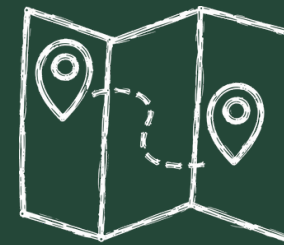



HOTEL MAP

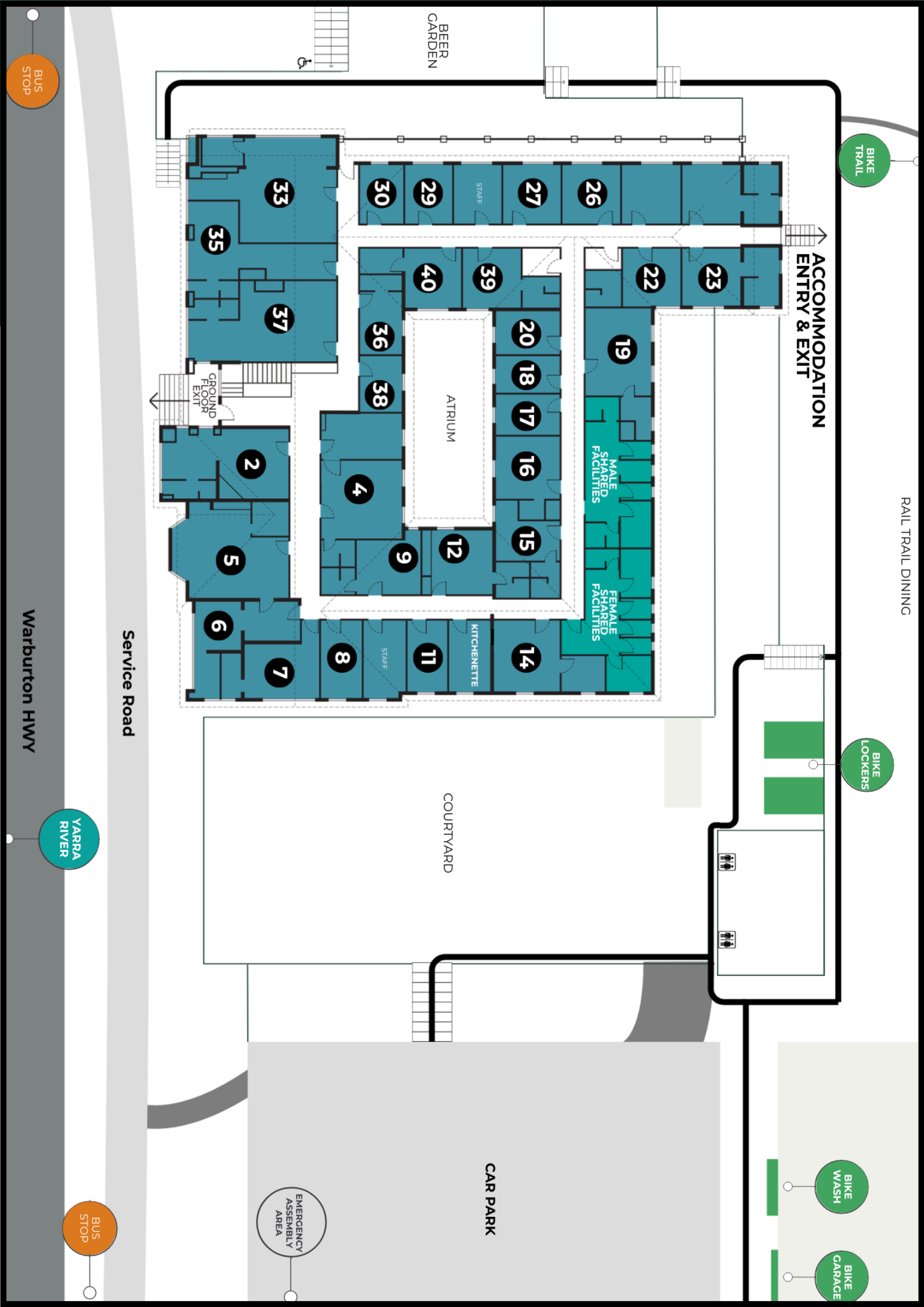
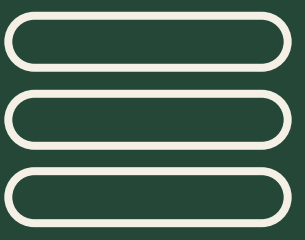

TAP ICONS TO NAVIGATE

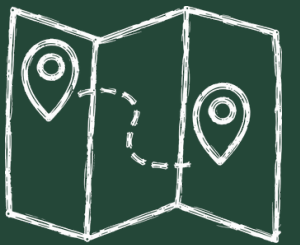



DINING

BOOK

Buffet Breakfast

Start your morning with our buffet breakfast, featuring a mix of hot and cold options to set you up for the day. Available Saturdays & Sundays
\$35pp | \$16 ages 3-10

weekends 8:00am - 11:00am

Lunch

Enjoy a relaxed lunch in our dining room or bistro, with a mix of pub classics and seasonal dishes.

daily 12:00pm - 3:00pm

Dinner

Dinner is served with a range of hearty pub favourites and seasonal specials. Bookings are highly recommended.

daily 5:00pm - 8:00pm (8:30pm Saturday)

Drinks

Enjoy a selection of local beers, wines, and cocktails in the bar or beer garden.

Closing times vary day to day depending on trade and atmosphere.

daily 12:00pm - Late

TAP ICONS TO NAVIGATE

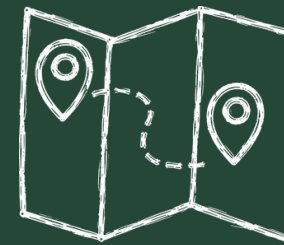

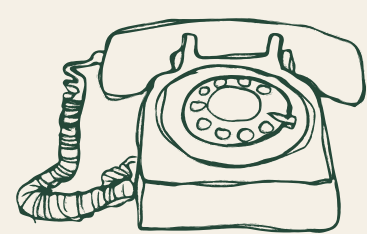

AMENITIES

Kitchenette

All rooms have access to our guest kitchenette, stocked with basic essentials for your stay.

This includes a fridge, dishwasher, sink, glasses, mugs, cutlery, sandwich press, instant coffee and tea from cosh alchemy, a local herbalist, .

Please clean up after use so all guests can enjoy the space.

Warburtanicals

Enjoy our locally made Warburtanicals products, created right here in Warburton.

You'll find them in your bathroom (or shared facilities), including shampoo, conditioner, body wash, and hand soap.

Made locally, they're designed to be gentle, fresh, and reflect the natural surrounds of the Yarra Valley.

Heating & Cooling

For your in-room comfort, you can adjust your heating and cooling to suit your personal needs.

For the best response, please point the remote at the roof unit, ensure you select from the appropriate settings, and wait at least 10 minutes.



TAP ICONS TO NAVIGATE

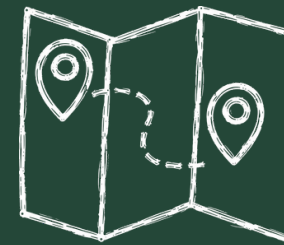

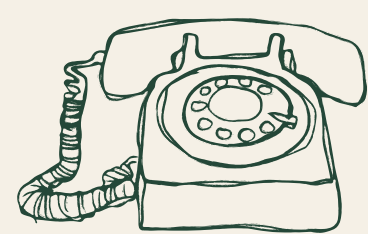

BIKING

Bike Lockers

Our individual bike lockers are perfect for securely storing push bikes during your stay.

Please ask our team for a key.

Bike Garage

Our larger bike garage can store up to 20 bikes and is suitable for guests with e-bikes who wish to charge their bikes (please bring your own charger)

Please ask our team for a key.

Bike Wash

A bike wash is located beside the storage area, perfect for cleaning down after a muddy ride.

Tap to pay.

Where to Ride

Warburton is home to some of Victoria's best riding trails, including the Warburton Rail Trail, Mount Donna Buang, the Warburton Bike Park, and nearby trail networks.

[SEE MORE](#)

TAP ICONS TO NAVIGATE

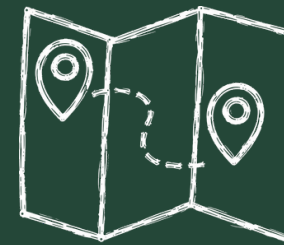

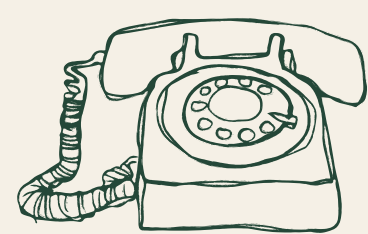

HOUSE RULES

1 No Smoking or Vaping

Our heritage building has very sensitive smoke alarms. Smoking or vaping indoors will trigger the fire alarm system, identify the room, and require a full hotel evacuation. Please be considerate. *Smoking is permitted outside, through the accommodation entry/exit.*

2 No Pets

We love our furry friends, but unfortunately pets are not allowed in hotel areas. This is for insurance reasons, so we're unable to accommodate them staying with us. Thank you for your understanding and cooperation.

3 Please be Considerate

Please think of other guests and keep noise to a minimum after 10:00pm. Please be considerate in shared hallways and spaces, keep TV volume to a reasonable level, and avoid loud partying in rooms.

4 Children

Children must be supervised by an adult at all times throughout the property. Please ensure children are not running through hallways or accommodation areas.

5 Shared Facilities

Please respect shared facilities and leave them clean and tidy for other guests to enjoy.

TAP ICONS TO NAVIGATE

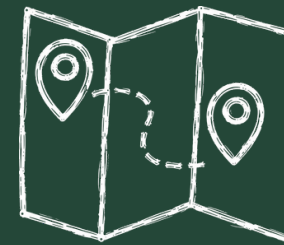

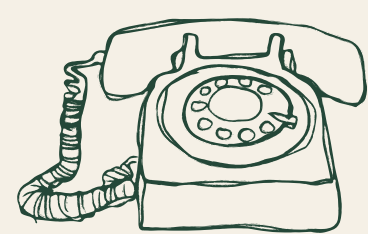

EXPLORE

Right on our doorstep, you'll find some of Victoria's most spectacular natural scenery. From towering mountain ash to fern-filled gullies and ancient rainforest trails, Warburton is made for exploring.

EXPLORE MORE

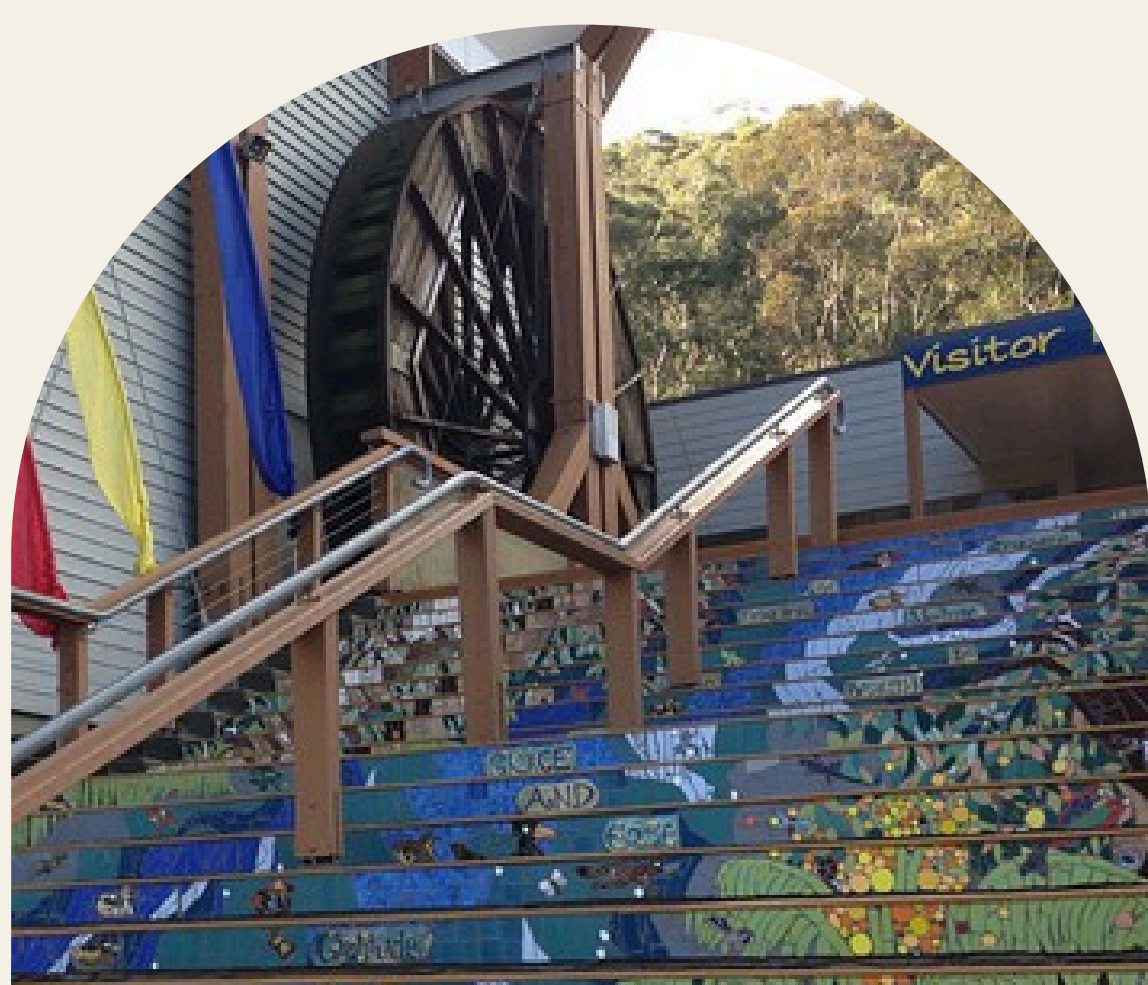

Water Wheel

1 min by car



Redwood Forest

12 min by car



Mt. Donna Buang

25 min by car



LaLa Falls

30 min by car

TAP ICONS TO NAVIGATE

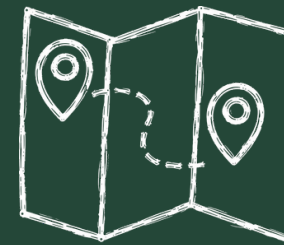

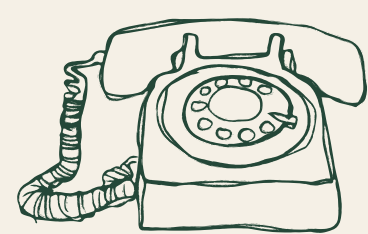

FAQ

How do I connect to WiFi?

Free WiFi is available throughout the hotel. Please ask reception for a WiFi code if you were not provided one.

Is parking available?

Yes, parking is available on-site. Please note it is public parking and not exclusive to accommodation guests.

How do I control my air conditioning?

Point the remote at the roof unit, ensure you select the appropriate settings, and wait at least 10 minutes.

[See How](#)

Need help after reception hours?

A night manager is available after reception hours for urgent matters or emergencies. For non-urgent requests, our team will assist you during reception hours.

[Contact](#)

TAP ICONS TO NAVIGATE

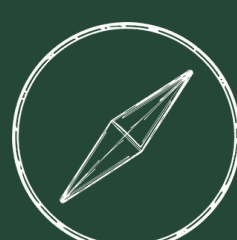
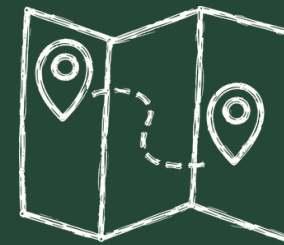

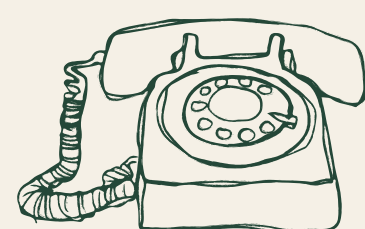

EMERGENCY

In the event of an emergency, please follow the instructions below.

EVACUATION PRODECURES

- Follow all instructions given by the Warden, Manager or Fire Officers
- Leave immediately by the safest exit
- Move quickly, DO NOT RUN
- Do not attempt to retrieve personal belongings
- Report to the designated Assembly Area
- Advise a Warden / Manager if you are aware of a person missing/trapped inside the building
- DO NOT leave the Assembly area OR re-enter the building, until Manager, Police or Fire Brigade provides authorisation
- Notify the warden/manager if any injuries have been sustained

IN THE EVENT OF A FIRE

RACE

Remove persons from the immediate danger area

Alert nearby staff and members of the public and call **000**

Confine fire and smoke by closing doors and windows. Keep low, under the smoke

Extinguish and control the fire (if safe to do so)

ACCOMODATION FLOOR NOT TO SCALE

MARCH 2026

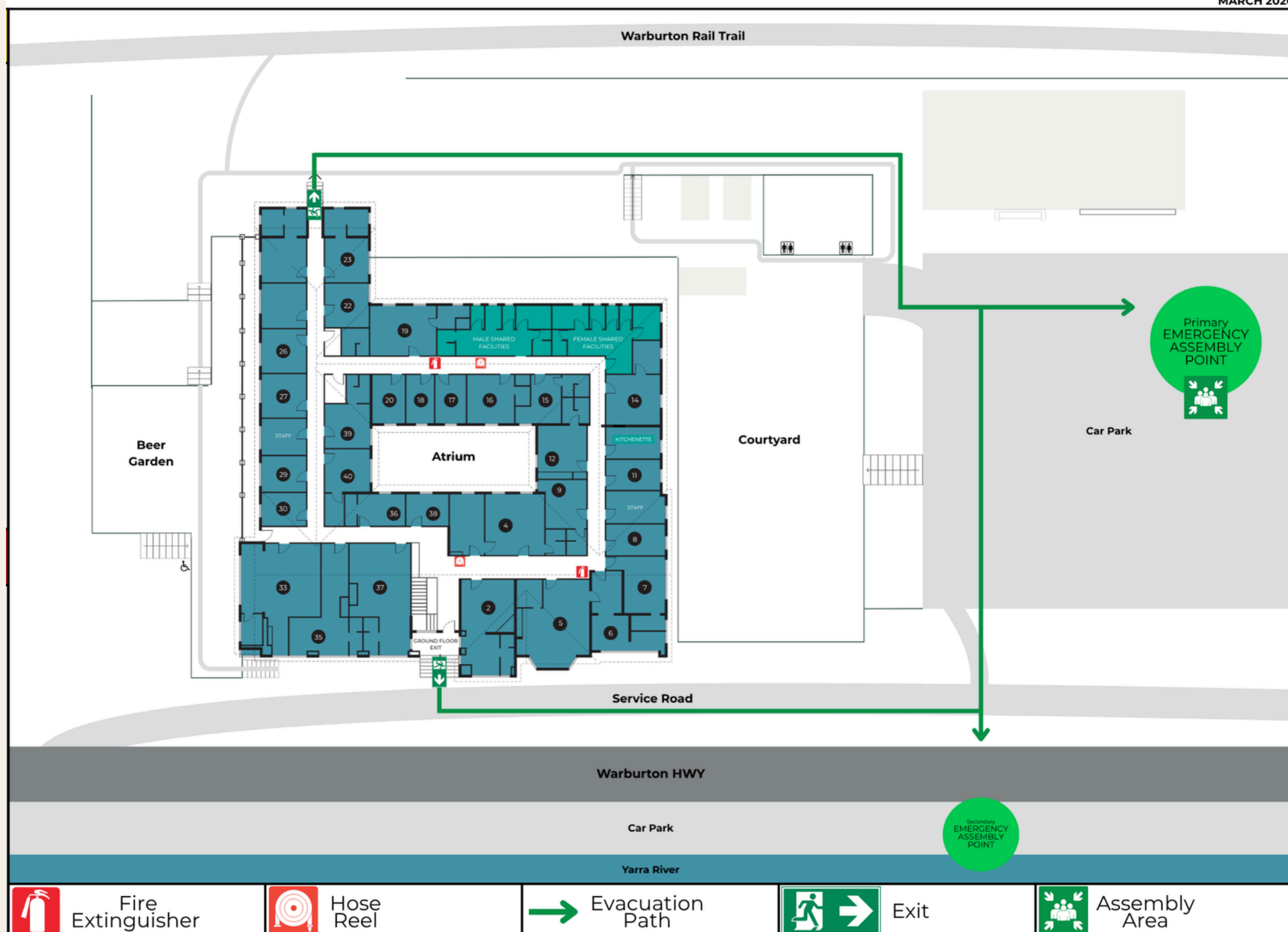

TAP ICONS TO NAVIGATE

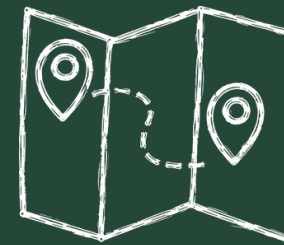

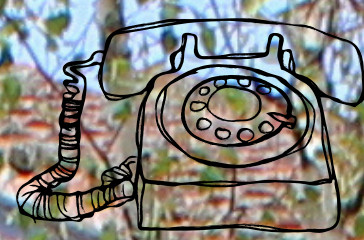
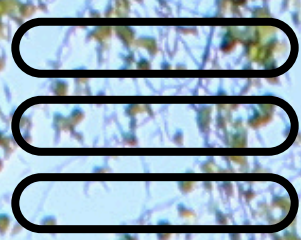

THE
ALPINE
hotel

PLEASE LEAVE US A REVIEW

If you enjoyed your stay, please consider leaving us a review.

Your feedback helps us as a family-owned business and helps future guests discover the beauty of Warburton and the Yarra Valley.



If there's anything about your stay that didn't meet expectations, please send us an email.

We'd love the opportunity to make things right and ensure you have the best possible experience with us.

bookings@alpineretreat.com.au

TAP ICONS TO NAVIGATE

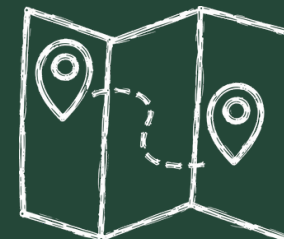



CONTACT



(03) 5966 2411

Reception Phone

Night manager will answer after hours



bookings@alpineretreat.com.au



alpineretreat.com.au



[thealpinehotelwarburton](https://www.instagram.com/thealpinehotelwarburton)



[Alpine Hotel Warburton](https://www.facebook.com/AlpineHotelWarburton)

TAP ICONS TO NAVIGATE

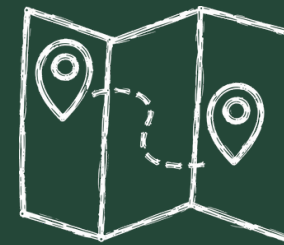

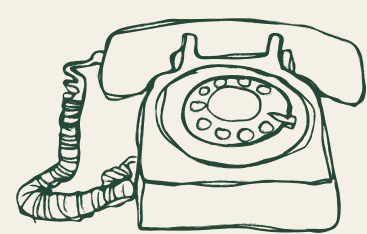

We look forward to staying in touch and welcoming you back soon!

Follow us



thealpinehotelwarburton



Alpine Hotel Warburton



LET'S STAY IN TOUCH

TAP ICONS TO NAVIGATE

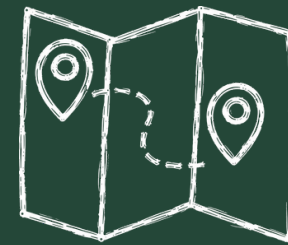



Thank you for your stay

Thank you for choosing to stay with us at the Alpine Hotel Warburton. We hope you've had a memorable stay and truly enjoyed your time here.

We appreciate your support and would love you to share your experience with others.



THANK YOU

TAP ICONS TO NAVIGATE



RAIL TRAIL DINING

BIKE TRAIL

BIKE LOCKERS

BIKE WASH

BIKE GARAGE

ACCOMMODATION
ENTRY & EXIT

BEER GARDEN

MALE
SHARED
FACILITIES

FEMALE
SHARED
FACILITIES

CAR PARK

COURTYARD

ATRIUM

KITCHENETTE

EMERGENCY
ASSEMBLY
AREA

Service Road

BUS STOP

BUS STOP

YARRA RIVER

Warburton HWY

